

Model 3100E & 3100P/P1 Liquid Level Switches

Specifications

Model 3100E

Process connection: 2" MNPT
 Maximum operating pressure
 Stainless steel float - 500 psig
 Syntactic foam float - 2000 psig
 Minimum operating specific gravity
 316 stainless steel float: 0.68
 Syntactic foam float: 0.50
 Leadwires: 18 AWG x 36" long

Model 3100P/P1

Process connection: 2" MNPT
 Maximum operating pressure
 Stainless steel float - 500 psig
 Syntactic foam float - 2000 psig
 Supply pressure connection
 1/8" FNPT
 Exhaust connection: 1/4" FNPT
 Supply pressure: 30 to 60 psig
 Minimum operating specific gravity
 316 stainless steel float: 0.68
 Syntactic foam float: 0.50

The model 3100E is an electric, float-operated switch which can be used as a high or low level alarm or for liquid level control.

*Model 3100E
 Electric Level
 Switch*

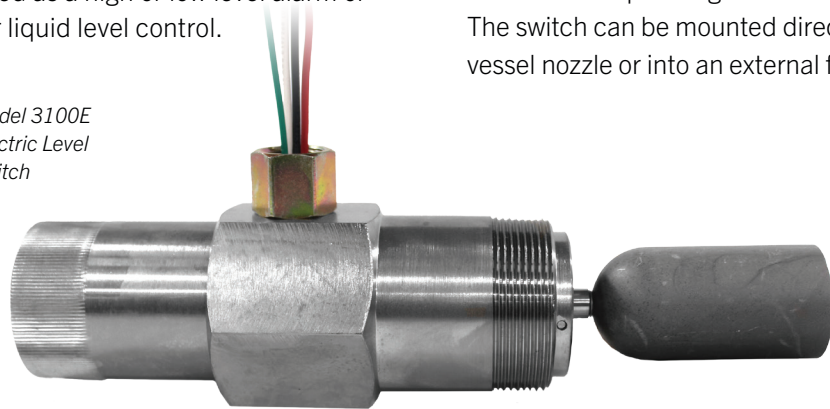

The 3100E is rated for high pressure applications. The float will effectively and consistently operate the switch at specific gravities as low as 0.50. The switch can be mounted directly onto the vessel nozzle or into an external float chamber.

The model 3100P and 3100P1 are pneumatic, float-operated switches for liquid level control. The 3100P is a 2-way normally-open or normally-closed switch and the 3100P1 is a 3-way block-and-bleed switch.

The 3100P and 3100P1 are rated for high pressure applications. The float will effectively and consistently operate the switch at specific gravities as low as 0.50. Both models can be mounted directly onto the vessel nozzle or into an external float chamber.

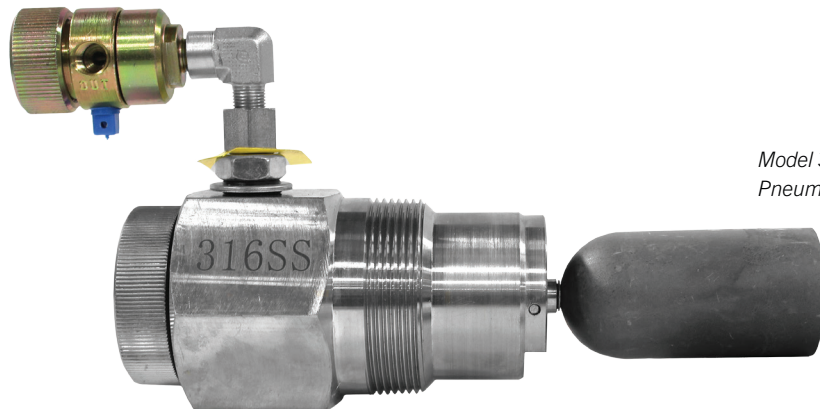

*Model 3100P/P1
 Pneumatic Level
 Switch*

NOTE: Taylor Valve reserves the right to change product designs and specifications without notice.

Model 3100E & 3100P/P1 Liquid Level Switches

Dimensional Data (in.)

Model 3100E

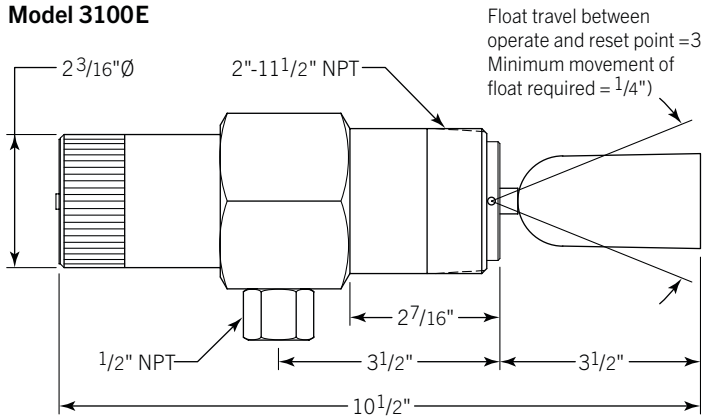

External Float Chamber - P/N 31124-2 (Standard)
P/N 31124N-2 (NACE)

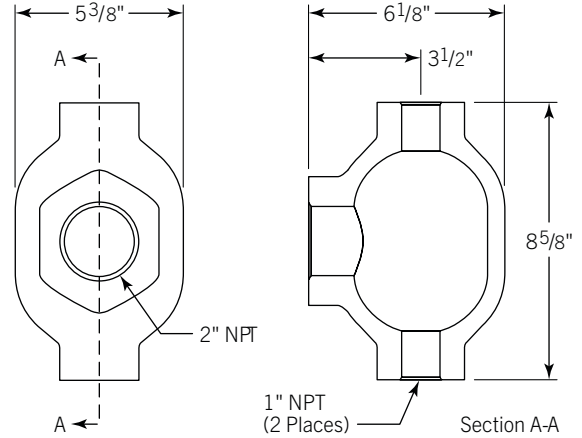

Model 3100P/P1

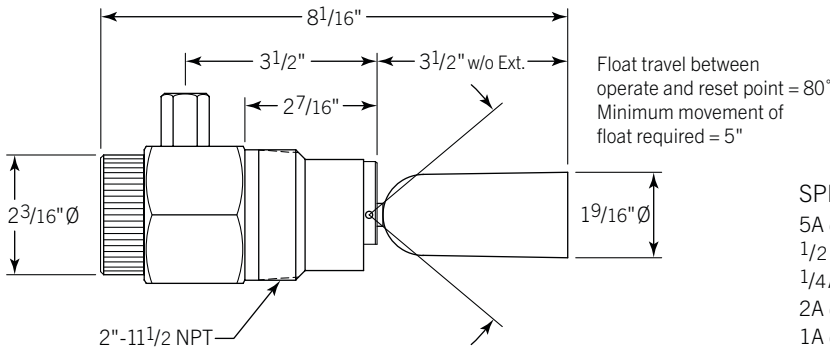

SPDT Switch Rating
5A @ 125-250-480 VAC
1/2 A @ 125 VDC
1/4 A @ 250 VDC
2A @ 6-30 VDC Resistive
1A @ 6-30 VDC Inductive

DPDT Switch Rating
10A @ 125-250 VAC
1/2 A @ 125 VDC
1/4 A @ 250 VDC
10A @ 6-24 VDC
Inductive/Resistive

Part Number Codes, Model 3100 P/P1

Part Number	Model Number	Body	Float (Viton® Seals)	Pilot
91000	3100P	CS	Syntactic	No
91001	3100P1	CS	SS, 1" Ext.	Yes
91002	3100P	CS	SS	No
91004	3100P1	CS	SS	Yes
91006	3100P1	CS	Syntactic	Yes
91008	3100P-SS	SS	Syntactic	No
91025	3100P1-SS	SS	Syntactic	Yes
91026	3100P1-SS	SS	SS	Yes
91027	3100P-SS	SS	SS	No
91206	3100P1	CS	Synt., 1" Ext.	Yes
91207	3100P	CS	Synt., 1" Ext.	No

Part Number Codes, Model 3100E

Part Number	Model Number	Body	Float (Viton® Seals)	Switch
91200	3100E	CS	Syntactic	SPDT
91201	3100E2	CS	Syntactic	DPDT
91210	3100E2	CS	SS	DPDT
91219	3100E	CS	SS	SPDT
91224	3100E2-SS	SS	SS	DPDT
91225	3100E-SS	SS	SS	SPDT
91227	3100E-SS	SS	Syntactic	SPDT
91232	3100E2-SS	SS	Syntactic	DPDT

NOTE: 1" & 4" extension rods available upon request

Materials of Construction

Description	Material
Body	LCC 316 Stainless Steel (Optional)
Float	Syntactic Foam (STD) 316 Stainless Steel (Optional)
Seals	Viton®

Temperature Limits

Model 3100E & 3100P/P1	
Syntactic Foam Float	Stainless Steel Float
-20 to 300°F (-29 to 200°C)	-20 to 400°F (-29 to 204°C)